

**TOWN OF OLDS  
BYLAW NO. 2022-01**

A bylaw of the Town of Olds, in the Province of Alberta, pursuant to provisions of the Municipal Government Act, being Chapter M-26 of the Revised Statutes of Alberta 2000, and amendments thereto, to provide for the amendment of Municipal Development Plan Bylaw No. 2020-14

**WHEREAS**, Section 632(1) of the Municipal Government Act, being Chapter M-26 of the Statutes of Alberta, and amendments thereto, requires that every Council of a municipality must by Bylaw adopt a Municipal Development Plan;

**WHEREAS**, a Municipal Development Plan has been prepared and adopted in accordance with the Municipal Government Act, being Chapter M-26 of the Revised Statutes of Alberta 2000, and amendments thereto;

**WHEREAS** the Municipal Government Act, being Chapter M-26 of the Revised Statutes of Alberta 2000, and amendments thereto, permit a Council by bylaw to amend the Municipal Development Plan; and

**WHEREAS** the Council of the Town of Olds deems it necessary and expedient to amend Municipal Development Plan Bylaw No. 2020-14

**NOW THEREFORE, the Council of the Town of Olds duly assembled enacts as follows:**

1. **THAT** Map 1: Significant Features be replaced with the drawing attached as Schedule A.
2. **THAT** Map 2: Future Land Use Concept be replaced with the drawing attached as Schedule B.
3. This Bylaw comes into force on the date it is passed.

Read a first time on the 28 day of March, 2022.  
Public Hearing held on the 25 day of April, 2022.  
Read a second time on the 25 day of April, 2022.  
Read a third and final time on the 25 day of April, 2022.

  
\_\_\_\_\_  
Judy Dahl  
Mayor

  
\_\_\_\_\_  
Sheena Linderman  
Interim Chief Administrative Officer

SIGNED by the Chief Elected Officer and the Chief Administrative Officer this 26 day of April, 2022.



Schedule A of Bylaw No. 2022-01

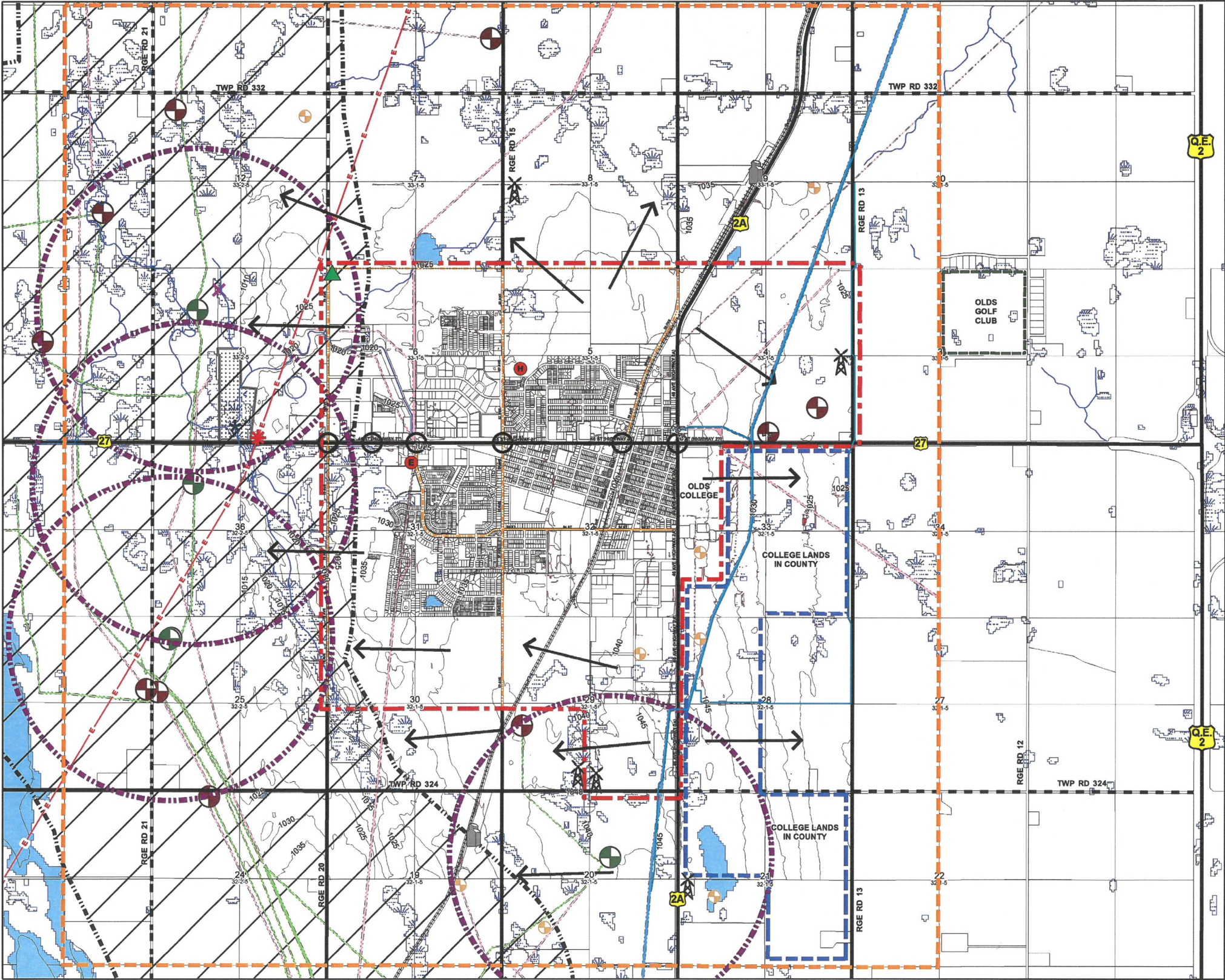



**Town of  
OLDS**



**MUNICIPAL DEVELOPMENT PLAN**

**SIGNIFICANT FEATURES**

- Town Boundary
- Study Area Boundary
- Major Paved Road
- Major Town Roads
- Gravel County Road
- Railway - Canadian Pacific Railway
- Power Transmission Line
- 5m Contour Interval (2013)
- General Slope of Land
- Creek/Ditch
- Wetlands (Subject to Confirmation)
- Pond/Slough
- Former Landfill
- Sour Oil/Gas Pipeline ROW
- Sweet Oil/Gas Pipeline ROW
- Sour Pipeline Right-Of-Way Within 1.5km
- Sour Well Within 1.5 km
- Oil/Gas Facility
- Active Sweet Oil/Gas Well With 100m Setback
- Active Sour Oil/Gas Well With 100m Setback
- Abandoned Oil/Gas Well
- Key Intersection
- Regional Water Supply Line
- Regional Lift Station
- Power Substation
- Olds Creek Wetland (Storm Water Project)
- Telecommunications Tower
- Grain Elevator
- Hospital
- RCMP/EMS Station

Town Boundary has been shifted for visual purposes.

MAP 1





1. This map shows generalized indications of land use and is not intended for scaling or detailed design.
2. The land use patterns must be interpreted with the text of this plan. Detailed land use and boundaries will be identified through area structure plans.
3. Town Boundary has been shifted for visual purposes.
4. The land uses and features shown beyond the Town Boundary are intended as information only. The policies of this plan do not apply to lands outside the Town Boundary.

